	<h1>GABLE ROOF CARPORTS/PATIO COVERS</h1>	Updated 2/2024	
Physical Address: Auburn City Hall Annex, 2 nd Floor 1 E Main St	Mailing Address: 25 W Main St Auburn, WA 98001-4998	Webpage & Application Submittal: www.auburnwa.gov mybuildingpermit.com	Phone and Email: Phone: (253) 931-3090 permitcenter@auburnwa.gov

WHAT YOU NEED TO APPLY FOR A BUILDING PERMIT:

- ☐ **Site Plan**– (see sample [site plan link](#)) A drawing of your lot and the setbacks to the property lines and other structures.
- ☐ [Permit Application](#)
- ☐ **Footing Details** Size and depth of footings.
- ☐ **House & Post Attachment Details**-List types of fastening/connectors being used. Ledger attachments shall show flashing, size of ledger being used, and anchor spacing.
- ☐ **Plan View Drawings of Patio Cover/Carport**- Please provide a birds eye view of your project, with all dimensions indicated. If you are designing this yourself, graph paper can be used (1 square=1 foot)or architectural scale. Measurements are critical on all building plans. The more information the better.
- ☐ **Cross-Section Drawings of Patio Cover/Carport**- Indicate distance between posts on plans.
- ☐ **Roof Framing Details**- Spans of rafter & beams-roof pitch/details, and dimensions of all material. Indicate roofing material and type of roof sheathing being used.

NOTES:

1. This is not an all-inclusive list. Conditions which do not meet these details may require a more detailed plan submission, up to and including engineer-stamped plans.
2. All lumber in contact with the ground or concrete shall be treated or rated for this use.
3. All screws or nails shall be hot dipped galvanized or stainless steel, and nails shall be ring shanked or annular grooved.
4. Patio Cover/Carports shall be constructed in accordance with the International Residential Code.
5. **Applications are submitted electronically via email. For more information, please see [Electronic Submittal](#).**
6. For further questions about this process, please contact permitcenter@auburnwa.gov or (253) 931-3020 Option 1.

CROSS-SECTION ATTACHED GABLE ROOF PATIO COVER/CARPORT PLAN

Gable Roof, Not to exceed 12 feet from supporting structure

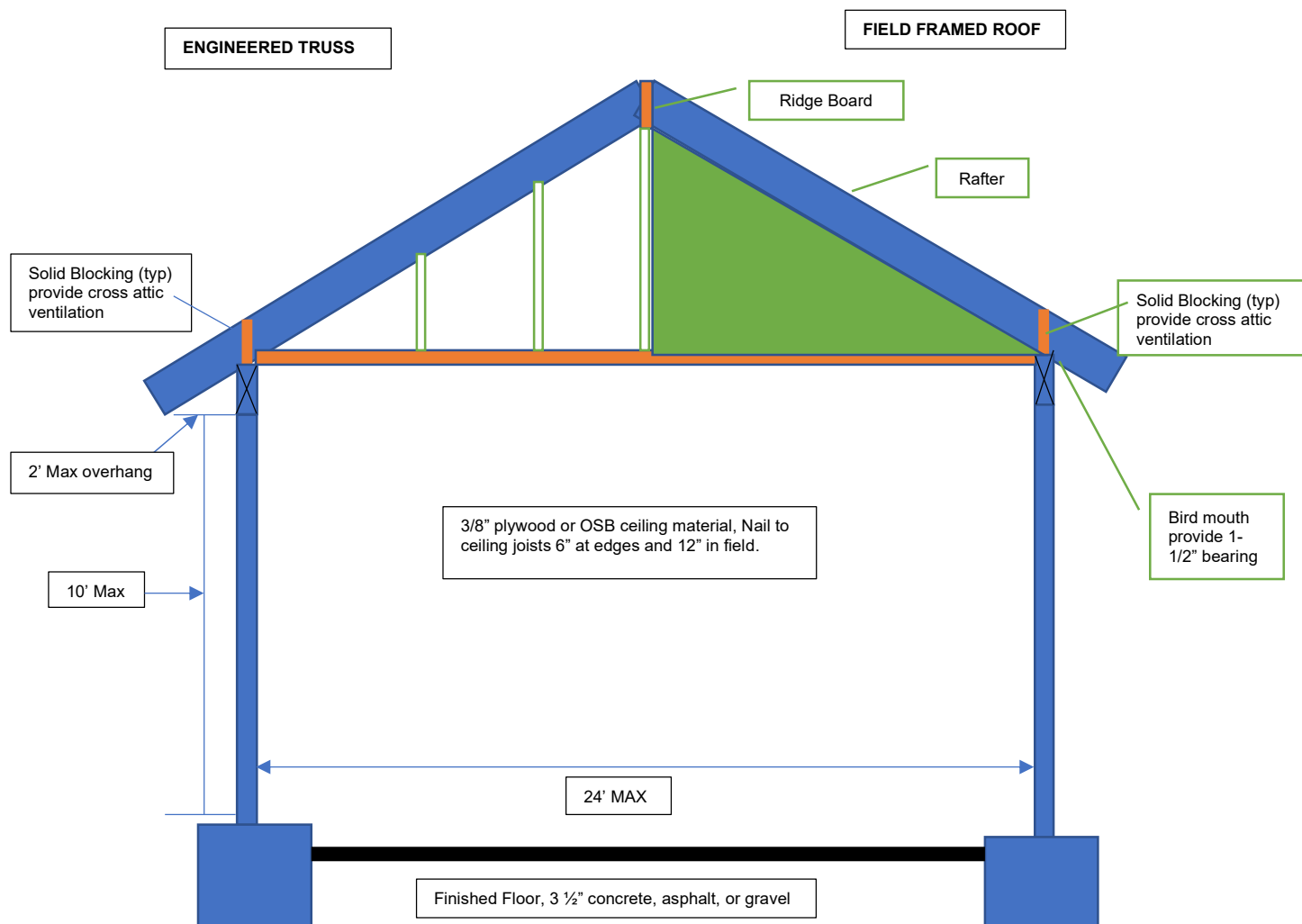

Notes:

1. All lumber must be kiln dried Douglas Fir #2 unless noted otherwise.
2. Cut ends of field framed rafters must bear fully on ridge board or ridge beam.
3. Overframing must bear on a ledger board fastened to the underlying roof framing with (2) 16d nails at each underlying rafter/truss.
4. Ceiling joists tying all field framed rafters together are required.
5. Ceiling must be fully sheathed with minimum 3/8" plywood or OSB (oriented strand board)

DIRECTIONS: Fill in the blanks with dimensions and material which will be used to build the structure-please PRINT legibly.

Length _____ Width _____ Post Size _____ (Ex. 4x4x10) Post Spacing _____ (max. 12' apart)

Beam Size _____ (Ex. 4"x6"x12' see table) Manuf. Trusses? ____ YES ____ NO

Rafter Size _____ (Ex. 2"x6"x12' see table) Rafter Spacing _____ o.c. (Ex. 16" oc.)

Ceiling Joist Size _____ (Ex. 2"x6"x12' see table) Ceiling Joist span _____ o.c. (Ex. 16" o.c.)

Roofing Material _____ (Ex. Class A 3-tab shingles)

Underlayment _____ (Ex. 2 layers of #15 felt)

Footing size _____ (Min required 24" deep x 24" wide or 3" circle (typ))

ATTACHED: PLAN VIEW OF PATIO COVER/CARPORT PLAN

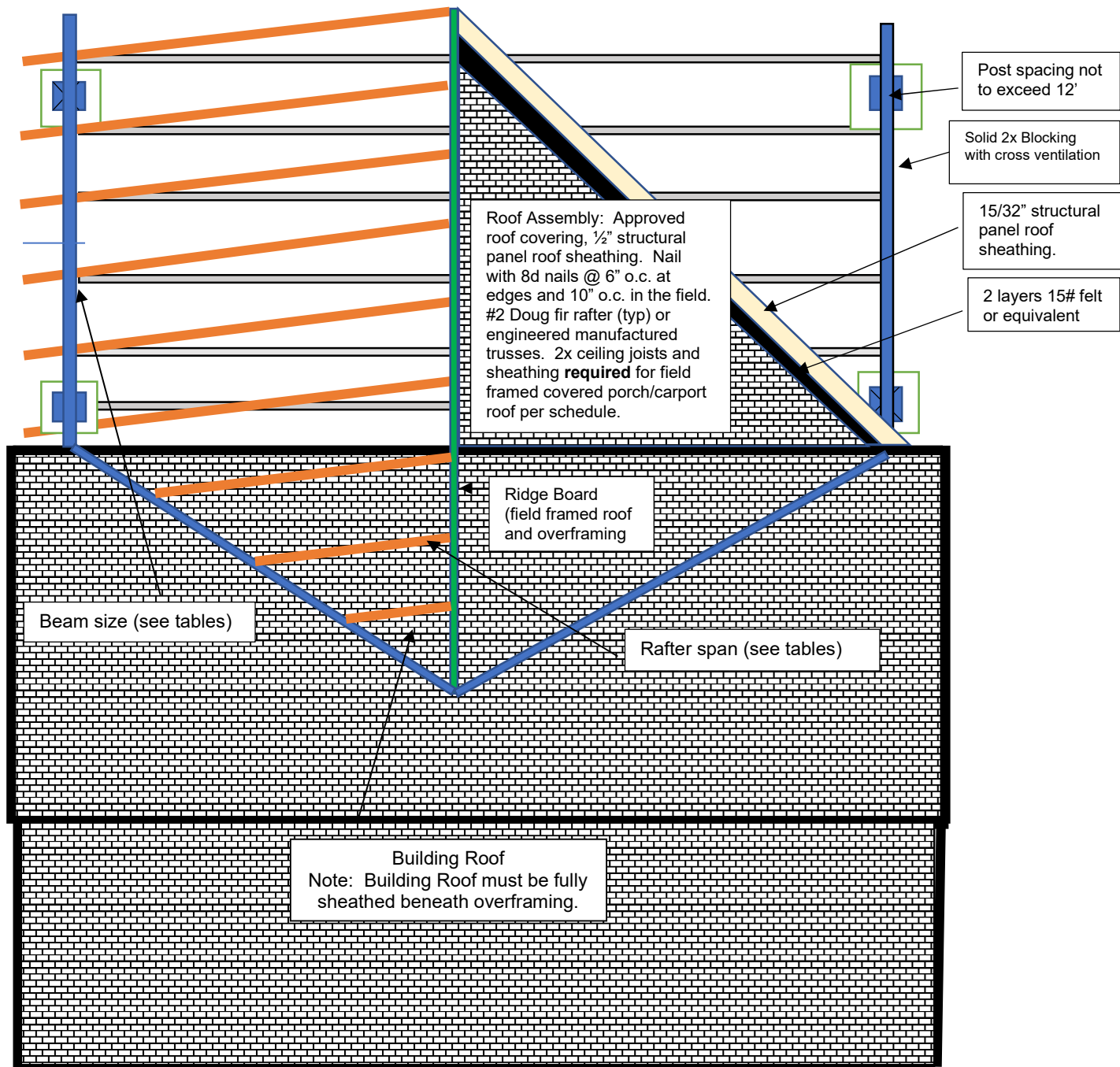

CONSTRUCTION DETAILS

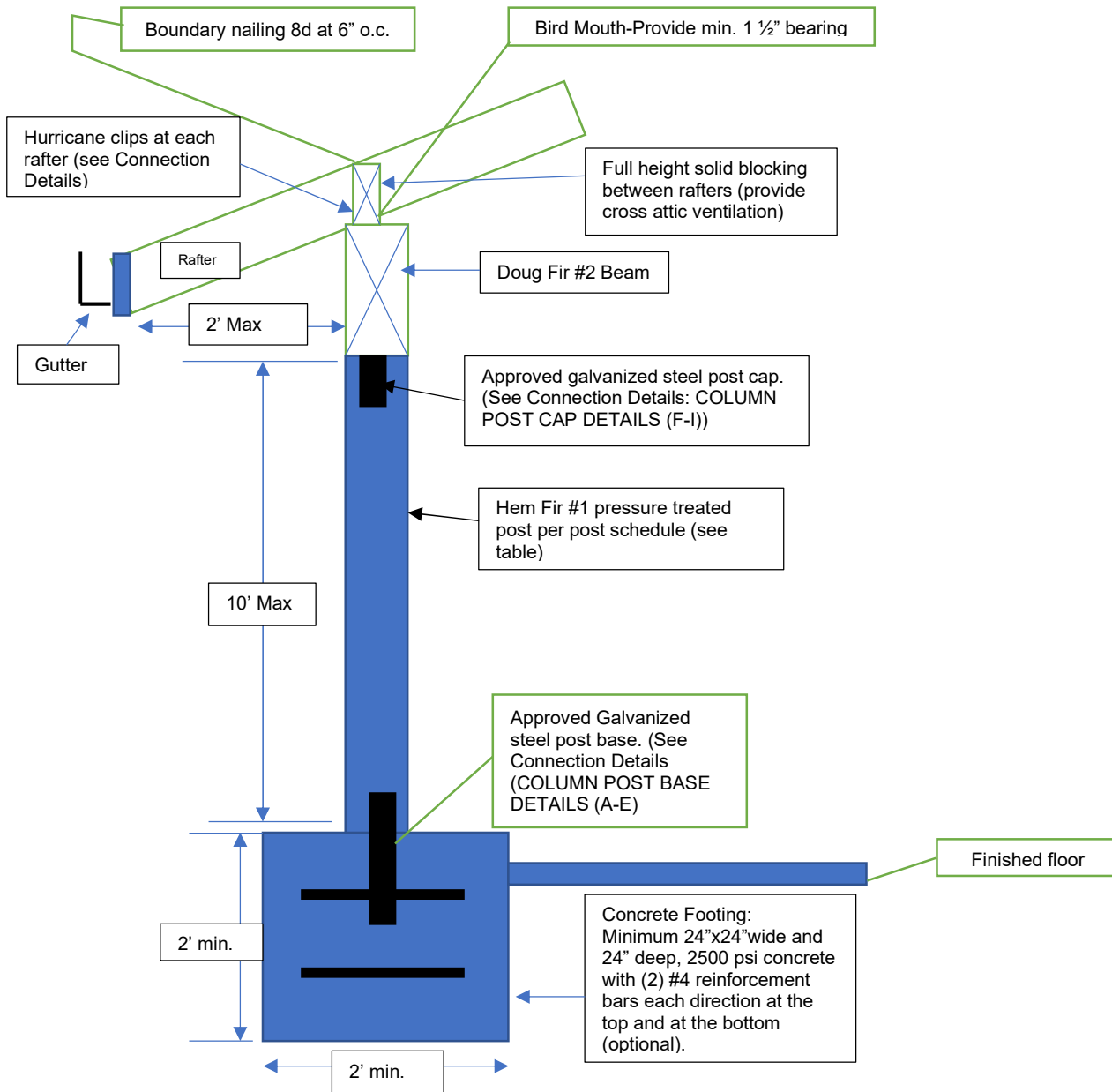

CONNECTION DETAILS

NOTES:

1. All bases, caps and connectors, are to be approved and listed products. Use manufacturer's specified fasteners per the product listing.
2. All bases, caps and connectors to be galvanized or coated with a corrosion resistant paint.

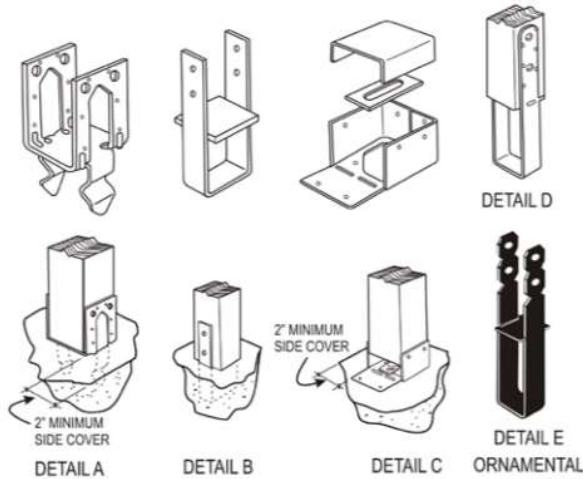

COLUMN / POST BASE DETAILS A-E

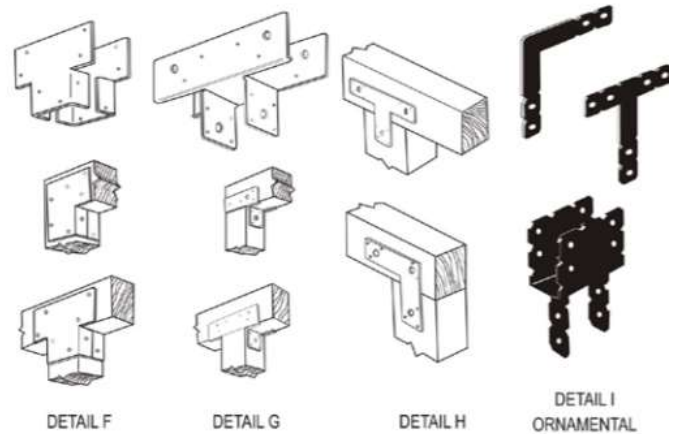

COLUMN / POST CAPS DETAILS F-I

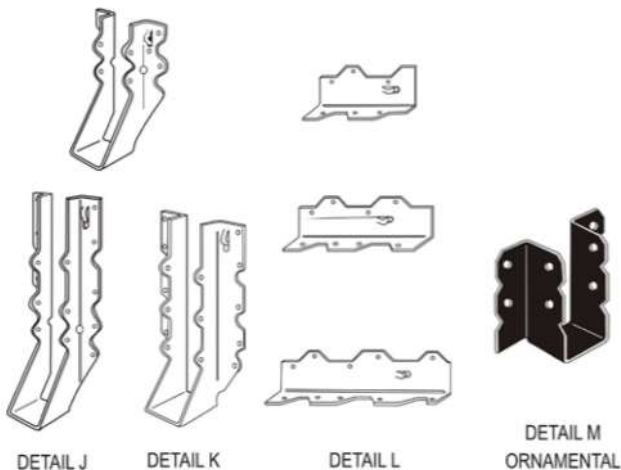

RAFTER CONNECTION J-M

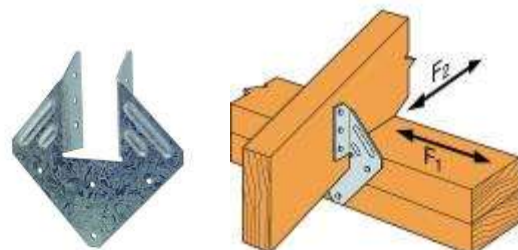

Hurricane Clip
(typical)

MEASUREMENT DETAILS

